

CARL SUCHY & SÖHNE

WIEN 1822

In 1844, Carl Suchy & Söhne was awarded the prestigious title "Purveyor to the Court", due to the fact that his watches exceeded the highest expectations in regard to elegance and technical perfection. We continue this tradition by striving for the same ideals: highest quality craftsmanship as well as sophisticated, joyful, surprising and timeless design.

Combining Viennese elegance with Swiss precision.



NOT EVERY SECOND COUNTS



## IT'S TIME AGAIN FOR CARL SUCHY & SÖHNE

200 YEARS AGO THERE WAS ONLY ONE ADDRESS  
FOR LUXURY WATCHES IN THE AUSTRO-HUNGARIAN  
EMPIRE: CARL SUCHY & SÖHNE. THE LEGENDARY  
AUSTRIAN WATCH BRAND HAS RETURNED AND  
SHINES IN NEW SPLENDOR

There is no proof of Sigmund Freud sneaking a peek at his Carl Suchy & Söhne pocket watch whenever longing for the end of a therapy session – but it's a nice thought to ponder. Fact is, however, the father of psychoanalysis, just as Emperor Franz Joseph I and his wife, Empress Sisi, were amongst the watch brand's most loyal customers.

Founded in 1822 by watch master Carl Suchy, the brand soon evolved into a prosperous family business, which, with the help of his four sons, flourished during the 19th and 20th century. First-born son Carl Suchy founded a watch company in the famous Swiss watch manufacturing centre of La Chaux-de-Fonds. Meanwhile, his younger brother Hans opened a flagship store on the prominent shopping street Rotenturmstraße in the historical centre of Vienna. Carl Suchy & Söhne's watches attracted attention far beyond Austria's borders, delighted the international press at world fairs, were regularly awarded for their "perfect quality and elegance" and brought glamour to royal courts, aristocrats' country estates, and the salons of the intellectual elite. After a short creative break, Carl Suchy & Söhne, the Danube monarchy's most prestigious watchmaker, is back blending today's highest standards of watchmaking and a timeless design with the rich history of the Austro-Hungarian Empire.



CARL SUCHY JR  
Carl Suchy attending the 20th wedding  
anniversary procession  
of Emperor Franz Joseph I of Austria and  
Elisabeth (Sisi) in 1879



EMPEROR FRANZ JOSEPH I AND  
ELISABETH (SISI) OF AUSTRIA

# VIENNESE ELEGANCE MEETS TECHNICAL EXCELLENCE



Store Location  
Rotenturmstraße, Vienna



Carl Suchy & Söhne flagship store  
at Wenzelsplatz, Prague

Carl Suchy & Söhne watches have always displayed highest aesthetics and innovation. All timepieces were signed off personally by the watchmaker himself. To bear his name, they had to “exceed the expectation of the highest classes of society in regard to refined elegance and technical perfection.”

Already during Habsburg times, the Suchy family strongly believed in the unique combination of highest quality materials, timeless Viennese design and Swiss craftsmanship. We deeply respect this tradition. To guarantee the same level of excellence when creating Carl Suchy & Söhne’s watches, we proudly count on the outstanding skills of Marc Jenni, master watchmaker in the third generation and former honoured member of the exclusive Académie Horlogère des Créateurs Indépendants in Geneva. It takes seven months to manufacture the Waltz N° 1 according to the highest precision standards of Swiss watch manufacturing expertise.



Each timepiece is handcrafted by watch master Marc Jenni, a former member of the honourable Académie Horlogère des Créateurs Indépendants, at his atelier in Switzerland. It takes seven months to complete each timepiece.



Each Table Waltz is handcrafted in Vienna by watch master Therese Wibmer, who graduated from the prestigious watchmaking school Karlstein, which was founded by Emperor Franz Joseph I.



Stainless Steel Case  
White Dial



Stainless Steel Case  
Black Dial



Stainless Steel Case  
Blue Dial

## VIENNA

ONE CITY. ONE WATCH. ONE LEGACY.

Vienna is a timepiece that is far more than just a watch: it is an homage to Vienna – a city defined by its unique interplay of history, art, and elegance. Inspired by Viennese Modernism, the Vienna unites a clear, architecturally influenced design language with the perfection of traditional Swiss watchmaking.



# THE ART OF REDUCTION

The refined, geometric lines of the Vienna reflect the city's aesthetics – a reduction to the essentials, inspired by the precise architectural language of that era. Eric Giroud, the renowned designer of the Vienna, describes it as an homage to Viennese Modernism:

*“The dial features a meticulously crafted design with clear lines – it is very much Adolf Loos, very much Josef Hoffmann. I truly enjoyed immersing myself in this world. What fascinated me most was seeing how a brand with 200 years of history develops a new identity by integrating contemporary codes and modern lines.”*

Viennese Modernism taught us that true beauty lies in clarity – perfection in form and function. No superfluous ornamentation, just the essentials. The Vienna follows this exact principle: light and shadow dance across the dial, the hands glide soundlessly through time. And the rotating second disc, completing a delicate pattern with every revolution, beats in sync with the city's rhythm – a silent pulse that keeps Vienna in motion.





#### TECHNICAL FEATURES

**MOVEMENT:** Caliber CSS-V1 in collaboration with Vaucher Manufacture Fleurier – Côtes-de-Vienne decoration – Winding: automatic – Power-reserve: 48 hours – Jewels: 29 – **FUNCTIONS:** Hours, minutes, Carl Suchy & Söhne rotating second disc at 6 o'clock – **DIAL:** Variations: Day (white), Night (black & white), and Blue Danube (blue & white) – Indexes: rhodium-plated with Super-LumiNova filling – Finishing: galvanic treatment – **CASE:** Material: 316L stainless steel – Diameter: 39 mm – Lug-to-lug: 41.2 mm – Height: 7.9 mm – Water-resistant to 3 atm / 30 meters – Crown with engraved Carl Suchy & Söhne pattern – Sapphire crystal with anti-reflective coating on both sides; screw-down case back – Engraved serial number – **STRAP:** Genuine leather 20 mm x 18 mm with quick-release spring bars – Colour: Day, Night (black) Blue Danube (blue) – Circumference of the leather strap from 150 mm to 190 mm – Decorated on the inside with micro-engraved details from the roof of St. Stephen's Cathedral – **CLASP:** 316L stainless-steel deployant clasp with Carl Suchy & Söhne pattern – **SWISS MADE:** Crafted in Switzerland, presented in a genuine leather travel pouch integrated into a handcrafted velvet case – made in Vienna, with the unique Carl Suchy & Söhne design



# A WATCH IN TUNE WITH THE CITY

*„Many small details make the Vienna a unique timepiece  
– from our exclusive Côte de Vienne finish and the golden  
micro-rotor with engraved double griffins to the distinctive dial  
ornamentation with its rotating second disc.“*

Vienna is not just architecture and design – it is also sound. The city pulses to the rhythm of its history: the deep tolling of the cathedral bells, the soft rattle of the trams, and the first notes of an aria drifting into the night from the Vienna State Opera. The Vienna follows this rhythm – its mechanical heart beats in sync with the city's soul.

The Vienna is for those who do not simply visit Vienna but feel it. For those who know that true elegance does not need to be loud. A watch that unites past and present – a love letter to a city that defies definition. Vienna must be experienced.





Stainless Steel Case  
White Dial



Stainless Steel Case  
Black Dial



Stainless Steel Case  
Blue Dial

## BELVEDERE

Coming spring Carl Suchy & Söhne presents the elegant yet sporty wristwatch. The Belvedere subtly alludes to the imperial heritage of the former purveyor to the royal court and is the ideal companion for a meditative stroll through the baroque garden of the eponymous palace. Indeed, with the robust timepiece you can also dive into crystal-clear lakes, or enjoy a skiing tour through powdery snow. The watch pays tribute to Austria's incomparable cultural landscape and reflects the elegant Viennese savoir-vivre.





#### TECHNICAL FEATURES

Case: Stainless steel – Diameter: 40.80 mm – Mechanical automatic movement - CCS 3 with Dubois Dépraz module – Swiss Made - Visible movement through the transparent sapphire crystal case back – Dial: various colours with Superluminova indices – Hours, minutes, seconds, and date display with central rotating disc – Rotor: gold-plated and special engraving of the Belvedere Castle – Hands: rhodium-plated with Superluminova – Bracelet: high-quality rubber bracelet with unique Belvedere design – Clasp: stainless steel folding clasp 316L.

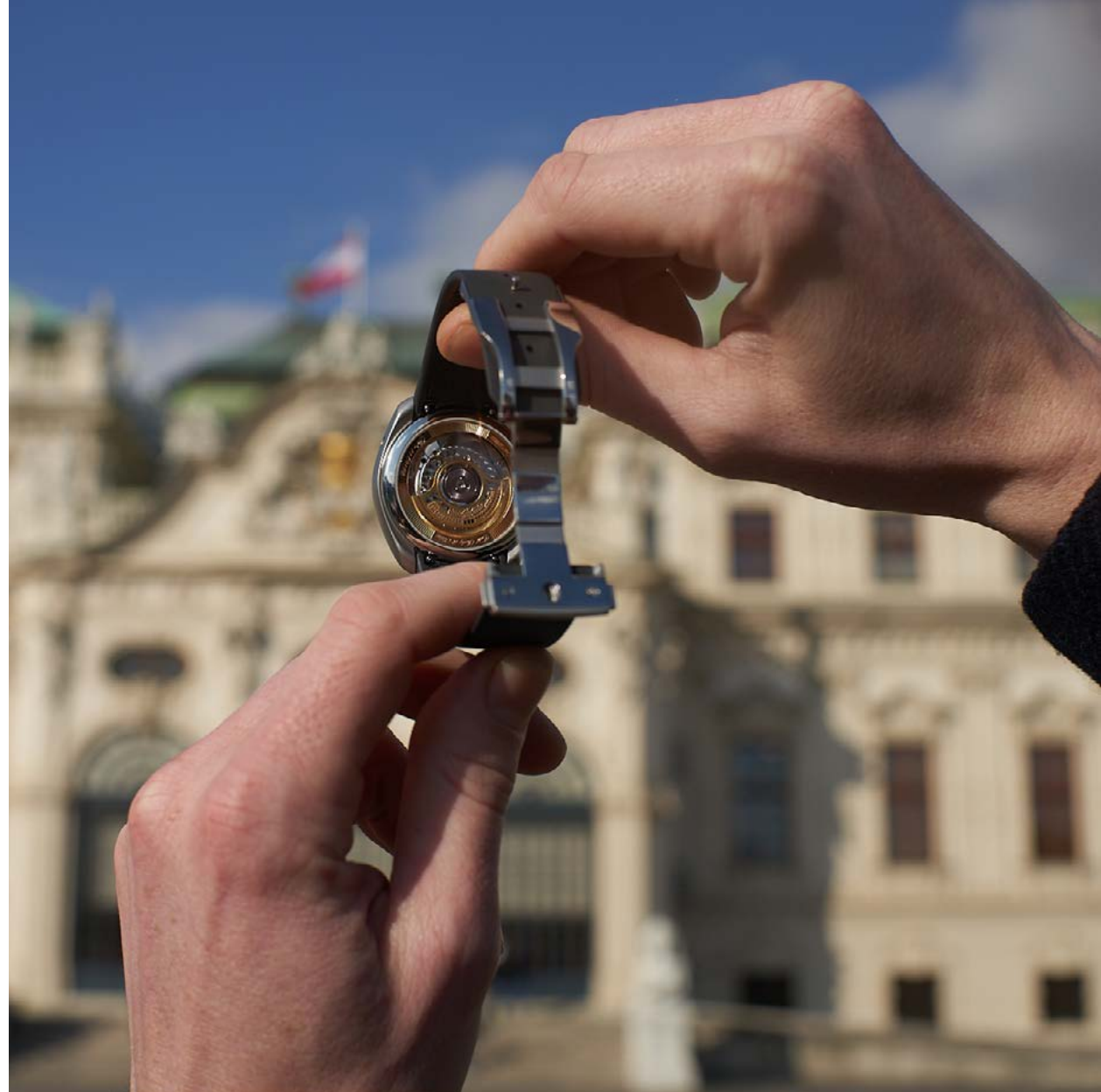



BELVEDERE TITAN  
Titan Case  
Grey Dial



BELVEDERE MIDNIGHT  
Black (DLC) Stainless Steel Case  
Black Dial

## BELVEDERE EFFORTLESS ELEGANCE

With the Belvedere Midnight & Titan, we are expanding our Belvedere collection with two further variants that focus even more strongly on the sporty, robust character of the watch, while still retaining its elegance.

Through the targeted emphasis on colour and material, the sportiness of the Belvedere Titan and the Belvedere Midnight is underlined in a subtle way. The elegance comes to the fore in a different guise, with the unique golden second hand shining with both detail and functionality.









BELVEDERE CHAMPAGNE  
Stainless Steel Case  
Champagne Dial



BELVEDERE BORDEAUX  
Stainless Steel Case  
Burgundy Dial

## BELVEDERE THE ART OF COLOUR

Embodying elegance and sportiness, the Belvedere Champagne and Bordeaux models distinguish themselves through their refined colour schemes and carefully chosen materials. The Champagne variant dazzles with its rich golden hues, while the Bordeaux captivates with its deep, luxurious red. Both watches feature a luminous golden second hand and Super-LumiNova filled indices, highlighting the meticulous craftsmanship and attention to detail that defines Carl Suchy & Söhne. Whether for formal occasions or casual outings, the Belvedere Champagne and Bordeaux watches add a touch of timeless sophistication with their elegant colour tones.



## TABLE WALTZ

Pure and contemporary in design, Carl Suchy & Söhne's Table Waltz radiates the elegance of Imperial Vienna. Its silky-smooth 25-cm-case, milled from a single brass piece, tenderly mantels the seemingly floating CS-T1 in-house movement featuring a pure silver bell that pleasantly chimes by the hour. The hand-polished and engraved glass on the front and back by J & L Lobmeyr fits seamlessly into the conical shape of the brass case. This exceptional and strictly limited-edition timepiece is developed and manufactured in Austria – the first of its kind in over 100 years.

### TECHNICAL FEATURES

CS-T1 in-house movement in characteristic Carl-Suchy- & Söhne-design, made in Austria. Designed by renowned designer Rainer Mutsch. Seven days power reserve. Hours, minutes, chime on the hour (can be locked). Key winder with overwind protection. 14 ruby stones. Dimensions: 25 cm height - 14.5 cm width - 8.5 cm depth. Weight: approx. three kilos. Mainplate: painted brass. Screws: blued steel. Gears: polished brass. Bell: hand-cast silver - blackened. Case: nickel-plated brass. Engraved limitation number. Personalized engraving of a special decoration is exclusively available.





## JUBILEE TABLE WALTZ

Carl Suchy & Söhne celebrates its 200th anniversary with the exclusive Special Edition Jubilee Table Waltz. In this very special clock, utmost attention is paid to each individual part. The key as well as the bell, consisting of a silver alloy, are gold-plated. The surface of the case is carefully polished, brushed, and patinated with black nickel. The inside is given a colourless glossy finish to make the highly skeletonized in-house movement CS-T1 shine. To protect the brilliant inside of the case, the movement is mounted in a floating way. Each timepiece is numbered from 1-10 and engraved with the years 1822-2022 to celebrate the anniversary. This time, the dial is black, and the hands are white. The glass is hand-cut, and a personalized engraving of a special decoration or dedication on it is exclusively available to make the Special Edition Jubilee Table Waltz a memorable object.





## TABLE WALTZ TOURBILLON

This unique work of art not only enriches our table clock collection, but also embodies an incomparable, timelessly modern aesthetic that is deeply rooted in the essence of the Carl Suchy & Söhne tradition. Carefully crafted by our experienced watchmaker in Austria, the tourbillon represents the highest art of watchmaking with over 50 exclusive components and compensates for gravitational time deviations.

The Table Waltz Tourbillon presents a captivating escapement and oscillating system that rotates on its own axis and represents an aesthetic evolution of our table clock collection.

The timeless design reflects the finesse of Viennese craftsmanship.





## WALTZ N°1



### MINIMALISTIC DESIGN AND HIGHEST-QUALITY CRAFTSMANSHIP

Around 1900, pure lines and understated elegance were the dominating features of Viennese Modernism. The most prominent proponents Josef Hoffmann, Otto Wagner, and Adolf Loos made it one of the most influential design movements of all time. It was the latter's commitment to puristic aesthetic and highest-quality materials that fundamentally inspired the design of our Waltz N°1.



1 — The curvature of the glass is carried on to the casing. 2 — The rounded and polished edging plays with the contrast of matte glazing and reflecting light. 3 — The polished lugs form a line parallel to the bezel and carry on its reflection. 4 — The curved watch-strap emerges from the polished lugs. 5 — The curvatures of the bottom and lower glass together form the conclusive face of the Waltz N°1.

Seamless connections: Design inspired by Adolf Loos can also be found at the divide of bezel and casing.

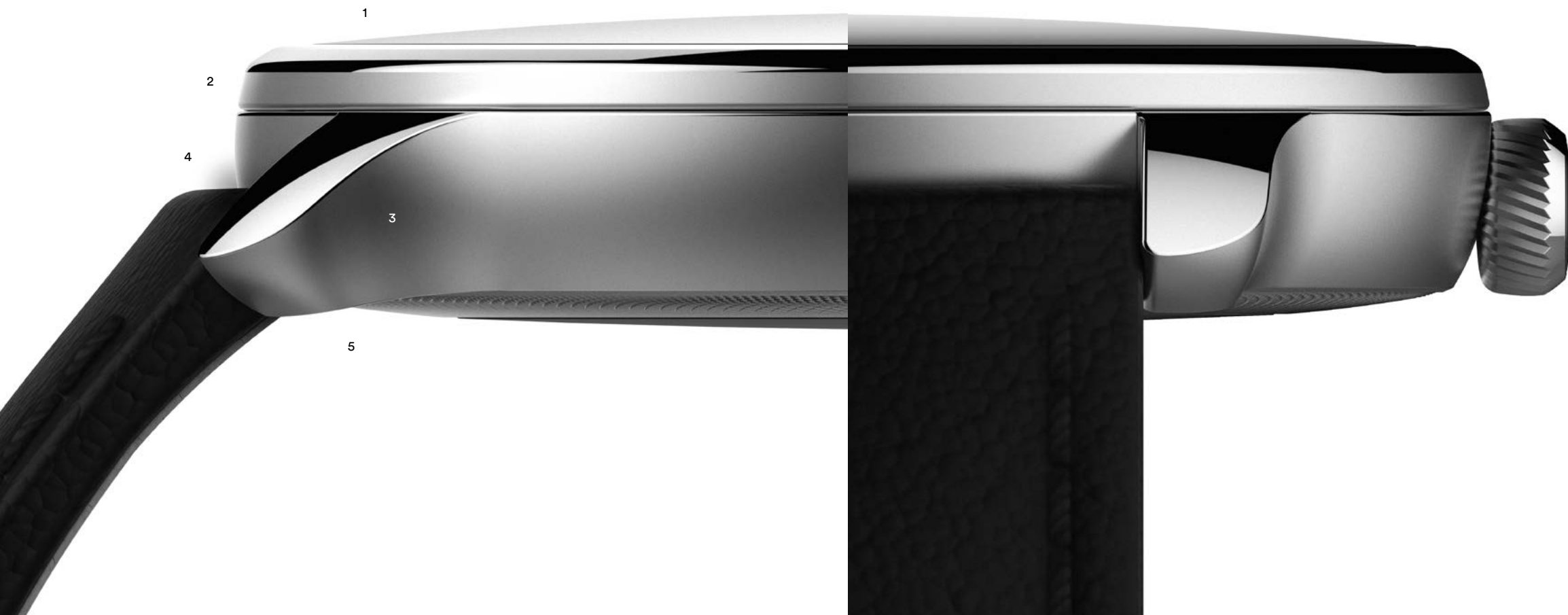

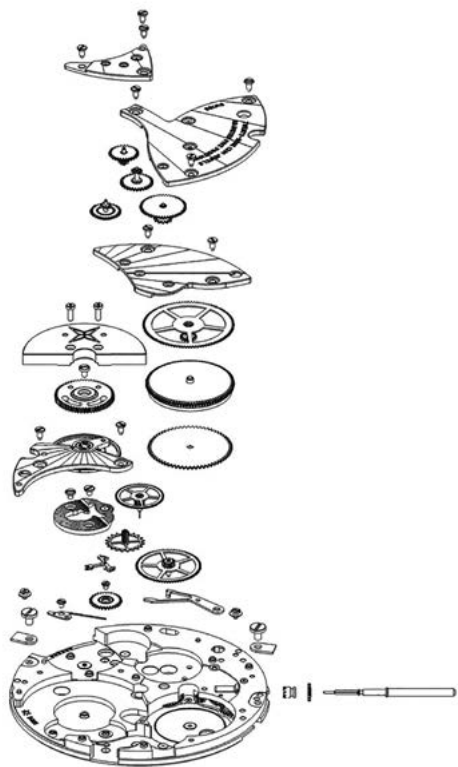

Mechanical self-winding caliber — Vaucher VMF 5401 — Manufacture Fleurier  
 Swiss-made — Visible through a transparent sapphire crystal case back — 29 rubies —  
 48 hours reserve — Water resistant up to 3 bar — 41,5 mm polished steel case — Hours, minutes,  
 and seconds — Seconds in the form of a turning “waltzing” disc at 6 — Black leather strap —  
 Adjustable 2-sided folding clasp with security push-pieces — solid wooden watch case



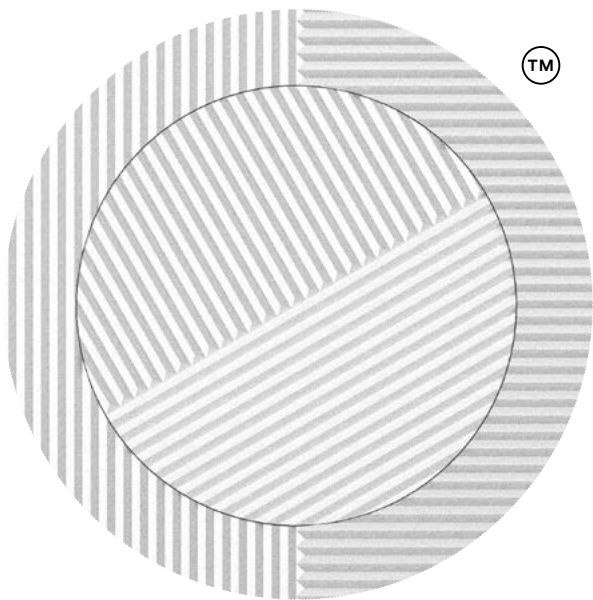

## WE DO NOT COUNT SECONDS IN VIENNA

Every full minute, the guilloché-facets of the rotating second disc align with those of the dial. The movement represents the joyful circles of the Viennese Waltz and the gregarious Viennese Coffee House culture, in which not every second counts.







## THE WALTZ N°1 MODELS



Black (ADLC)  
Stainless Steel Case  
Black Dial



Stainless Steel Case  
Blue Dial



Black (ADLC)  
Stainless Steel Case  
Silver Dial



Stainless Steel Case  
Black Dial



Stainless Steel Case  
Silver Dial

8008008

## WALTZ N°1 SKELETON

800

SPECIAL SERIES

Carl Suchy & Söhne's Skeleton Edition focuses on the playful design and the highest craftsmanship. The Waltz N°1 Skeleton is produced in a strictly yearly limited edition.

8008008







Stainless Steel Case  
Silver Dial



Stainless Steel Case  
Black Dial



Stainless Steel Case  
Blue Dial

## CARL SUCHY & SÖHNE'S AESTHETICS

The Waltz N°1 Skeleton's 41.5 mm dial has been carefully openworked along the subtle horizontal and vertical lines. Its unique design reveals just enough to enjoy the view of its refined ultra-thin skeleton movement caliber VMF5401/180.

## SOPHISTICATED CRAFTSMANSHIP

Held in stunning black PVD, the openworked bridges are rhodium-plated and hand-finished by extraordinary craftsmen. Fully visible through the transparent sapphire glass bottom, the movement is powered by a uniquely finished, decentralized micro-rotor providing the watch with 42 hours of autonomy.









Black (ADLC)  
Stainless Steel Case  
Silver and Black Dial

## WALTZ N°1 DAY & NIGHT

Flowing design transitions remind of the great designers and architects that shaped the aesthetics of Vienna around 1900. Like Yin and Yang, the second disc at 6 o'clock dances its circles, bringing together the seemingly contrasting colours in perfect harmony and then again dividing the dial into two perfect halves every full minute.

The Waltz N°1 Day & Night is the perfect companion for your discovery of Austria's capital, uniting the versatile faces the city has to offer: Visit the wonderful imperial sights during the day and set out for a night to remember in one of the many legendary cultural venues.



Stainless Steel case in silver & black  
Silver Dial with black second disc

## WALTZ N°1 MOLL

With the Waltz N°1 Moll, Carl Suchy & Söhne invites you to embark on a journey where time is not only measured, but felt and experienced. A dance with time that connects the past, present and future in a single, breathtaking moment. The Waltz N°1 Moll is not just a watch, but an expression of duration and transience, captured in the incomparable craftsmanship of Carl Suchy & Söhne.

With its rotating second disc in black, this watch pays homage to the somber beauty and deep emotionality of minor keys in music. Like the haunting yet elegant sound of a minor waltz, the Waltz N°1 Moll transports its wearer to a world where darkness and beauty unite to spin a timeless narrative.





## WELLNESS FOR YOUR WALTZ N°1

Our watch masters Marc Jenni and Therese Wibmer will personally maintain your unique timepiece. Our services range from providing replacement wristbands and polishing to a thorough cleaning of your timepiece.

To place a request or book a service, please contact:  
[office@carlsuchy.com](mailto:office@carlsuchy.com)



# TIMELINE

1796 — Carl Suchy is born in the historical centre of Prague.

1812-1819 — watchmaker apprenticeship and years of travel through Germany and Switzerland.

1821 — Carl Suchy marries Josephine Kroupa in Prague.

1822 — 26-year-old Suchy opens his watch shop in the centre of Prague. His technically advanced pendulum and wall clocks lead to rapid success.

1830 — Franz Joseph, the future emperor of Austria is born, as well as Suchy's second son Anton.

1832 — At the yearly Leipzig Trade Fair, which Suchy attends regularly, his products frequently win prizes. The quality of Suchy's

clocks matches the market-leading English and Swiss models.

1835 — On the occasion of the coronation of emperor Ferdinand Suchy equips the royal court in Prague with his clocks.

1838 — Suchy's business is growing, by now he has 35 employees. He is one of the first watchmakers to expand internationally.

1841 — Suchy's youngest son, Emanuel Suchy, is born. It is also the year of the birth of the famous Austrian architect and city planner Otto Wagner.

1844 — Due to the fact that "his watches exceed highest expectations in regard to elegance and technical perfection", Carl Suchy is appointed as the first – and for many years the only –

watch purveyor to the court.  
1848 — Coronation of Emperor Franz Josef I of Austria.

1849 — As Suchy's sons join the family business, it receives its name "Carl Suchy & Söhne" and quickly advanced to Austria's most renowned watchmaking company.

1853 — Carl Suchy Junior establishes a pocket watch factory in La Chaux-de-Fonds, Switzerland, the place of birth of world-famous architect Le Corbusier. The factory's products are shipped as far as France and Great Britain.

1855–1873 — Carl Suchy & Söhne clocks are regularly displayed at the world fairs in Paris, London, and Vienna. The trade press recurrently announces them to be the best Austrian products.

1862 — Artist Gustav Klimt and writer Arthur Schnitzler are born – both will have a tremendous influence on Viennese culture around 1900.

1863 — Suchy's second son Hans opens a workshop in Rotenturmstraße 6, in the centre of Vienna. The third son Johann Anton takes over the store in Prague. He is appointed purveyor to the court as well.

1865 — The Viennese Ring Road is opened and Austria's first horse-tramway is installed.

1866 — Founder Carl Suchy dies at age 70. His youngest son Emanuel takes over the workshop in Prague.

1867 — The Blue Danube Waltz by Johann Strauß premieres in Vienna.

1870 — The famous architects and designers Adolf Loos and Josef Hoffmann are born.

1872 — Emanuel Suchy establishes and manages Prague's first volunteer fire brigade.

1879 — Carl Suchy Junior attends the famous Makart procession

on the Ring Road, celebrating the twentieth wedding anniversary of Emperor Franz Joseph I of Austria and his wife Elisabeth. Suchy is proudly dressed as a watchmaker from the sixteenth century.

1886 — Esteemed customer, Sigmund Freud opens his practice in Vienna and develops the method of psychoanalysis.

1891 — The "Young Vienna Movement" coins what is still known as the Viennese coffee-house literature - the meetings and discussions of artists, writers, and intellectuals in Viennese cafés shape the literary movement in and around Vienna. Some of the most renowned members are Peter Altenberg, Arthur Schnitzler, Hugo von Hoffmannsthal and Stefan Zweig.

1894 — Emanuel Suchy receives the prestigious Knight's Cross of the Imperial Order of Franz Joseph I for his great support of the Prague fire Brigade.

1895 — Otto Wagner, one of the most influential architect of his time announces the end of ornamental historicism - Jugendstil takes its place.

Under the banner of modernism, philosophy, literature, music, art, design, and architecture blossom.

1898 — Hans Suchy dies. His widow Therese takes over the shop in the Rotenturmstraße in Vienna. She is also honoured as a purveyor to the court.

1907 — Adolph Cervinka is the new owner of "Carl Suchy & Söhne" in Prague. The store moves to the exclusive address Na Příkope in the centre of the city.

1918 — With the end of the Austro-Hungarian Empire, Carl Suchy & Söhne temporarily takes a creative break.

2017 — It is time again – for Carl Suchy & Söhne.

2021 — Release of the exclusive clock Table Waltz, designed and handcrafted in Vienna.

2022 — Carl Suchy & Söhne celebrates its 200-year anniversary.



#### BUY A WATCH

Online through our online shop, [www.carlsuchy.com](http://www.carlsuchy.com)

At our atelier or offices in Vienna, Zurich, or Lausanne -  
please arrange a meeting contacting [office@carlsuchy.com](mailto:office@carlsuchy.com)

Or in one of the exclusive boutiques of our partners - please visit our  
homepage for a list of our worldwide dealership network



#### PRESS

Please download our press pack at

[www.carlsuchy.com/press](http://www.carlsuchy.com/press)

For interview requests, images, and further inquiries please contact:  
[office@carlsuchy.com](mailto:office@carlsuchy.com)



#### GENERAL CONTACT

Your customer satisfaction is our greatest asset –

if you have any questions concerning Carl Suchy & Söhne and the  
collection of exclusive timepieces, please don't hesitate to contact us:  
[office@carlsuchy.com](mailto:office@carlsuchy.com)



[carlsuchy](#)



[carl-suchy-&-söhne](#)



[www.carlsuchy.com](http://www.carlsuchy.com)

BOOK A PRIVATE SHOWING  
WITH US



PRINZ EUGEN-STRASSE 48  
A-1040 VIENNA  
[OFFICE@CARLSUCHY.COM](mailto:OFFICE@CARLSUCHY.COM)  
+43 660 7524331



WWW.CARLSUCHY.COM

