



CARL SUCHY & SÖHNE

WIEN 1822





CARL SUCHY JR

Carl Suchy attending the 20th wedding anniversary procession of Emperor Franz Joseph I of Austria and Elisabeth (Sissi) in 1879



IT'S TIME AGAIN FOR CARL SUCHY & SÖHNE

150 YEARS AGO, THERE WAS ONLY ONE ADDRESS FOR LUXURY WATCHES IN THE AUSTRO-HUNGARIAN EMPIRE: CARL SUCHY & SÖHNE. NOW, THE LEGENDARY AUSTRIAN WATCH BRAND HAS RETURNED.

There is no proof of Sigmund Freud sneaking a peek at his Carl Suchy & Söhne pocket watch whenever longing for the end of a therapy session – but it is a nice thought to ponder. Fact is, however, the father of psychoanalysis, just as Emperor Franz Joseph I and his wife, Empress Sissi, were amongst the watch brand's most loyal customers.

Founded in 1822 by watchmaker Carl Suchy, the brand soon evolved into a prosperous family business, which, with the help of his four sons, flourished during the 19th and 20th century. First-born son Carl Suchy Junior founded a pocket watch company in the Swiss watch center of La Chaux-de-Fonds. Meanwhile his younger brother Hans opened a storefront on the prominent shopping street Rotenturmstraße in the historical center of Vienna. The Suchy's watches attracted attention far beyond Austria's borders, delighted the international press at world fairs, were regularly awarded for their "perfect quality and elegance," and equipped royal courts, aristocrats' country estates and the salons of the intellectual elite. Now, Carl Suchy & Söhne, the Danube monarchy's most prestigious watchmaker, returns, blending today's highest standards of watchmaking and a timeless design with the rich history of the Austro-Hungarian Empire.



Store Location
Rotenturmstraße, Vienna



Carl Suchy & Söhne flagship store
at Wenzelsplatz, Prague

WALTZ N°1

WHERE TRADITIONAL RIGOUR
MEETS TECHNICAL EXCELLENCE

Carl Suchy & Söhne's Waltz N°1 returns with the limited-series luxury watch Waltz N°1, made by hand in Switzerland. Carl Suchy's watches have always displayed highest aesthetics and innovation. All timepieces were signed off personally by the watchmaker himself: in order to bear his name, they had to "exceed the expectation of the highest classes of society in regard to refined elegance and technical perfection."

Already during Habsburg times, the Suchy Family strongly believed in the unique combination of high-end materials, timeless Viennese design and Swiss craftsmanship. We deeply respect this tradition. In order to guarantee the same level of excellence, we proudly count on the skills of Marc Jenni, master watchmaker in the third generation and honoured member of the exclusive Académie Horlogère des Créateurs Indépendants in Geneva, to create Carl Suchy & Söhne's watches. It takes seven months to produce the Waltz N° 1 according to the highest precision standards of Swiss watch manufacturing expertise.



Each Waltz N°1 is handcrafted by Watchmaker Marc Jenni, member of the honourable Académie Horlogère des Créateurs Indépendants, at his atelier in Switzerland. It takes seven months to complete the timepieces.



An aerial, black and white photograph of a large ballroom filled with couples dancing. The image is blurred to convey motion. A large black circle is superimposed in the center, containing the text 'WALTZ N°1' in white, sans-serif font.

WALTZ N°1



The automatic wristwatch expertly combines Viennese elegance with Swiss precision.
The exclusive time pieces are strictly limited to a single production series per year.



MINIMALISTIC DESIGN AND
HIGHEST-QUALITY CRAFTSMANSHIP

Around 1900, pure lines and understated elegance were the dominating features of Viennese Modernism. The most prominent proponents Josef Hoffmann, Otto Wagner and Adolf Loos made it one of the most influential design movements of all time. It was the latter's commitment to puristic aesthetics and highest-quality materials that fundamentally inspired the design of Waltz N°1.

1 — The curvature of the glass is carried on to the casing. 2 — The rounded and polished edging plays with the contrast of matte glazing and reflecting light. 3 — The polished lugs form a line parallel to the bezel and carry on it's reflection. 4 — The curved watch-strap emerges from the polished lugs. 5 — And the curvatures of the bottom and lower glass together form the conclusive face of the "Waltz N°1".

Seamless connections: design inspired by Adolf Loos can also be found at the divide of bezel and casing.

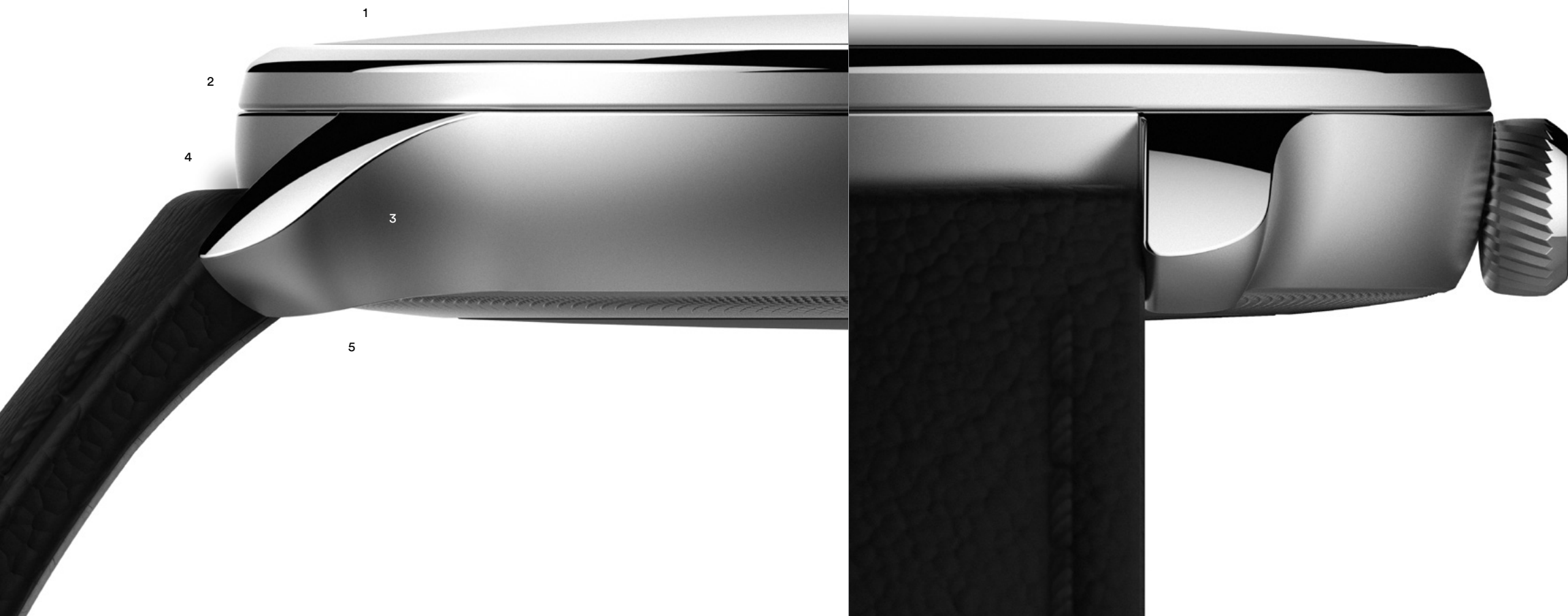

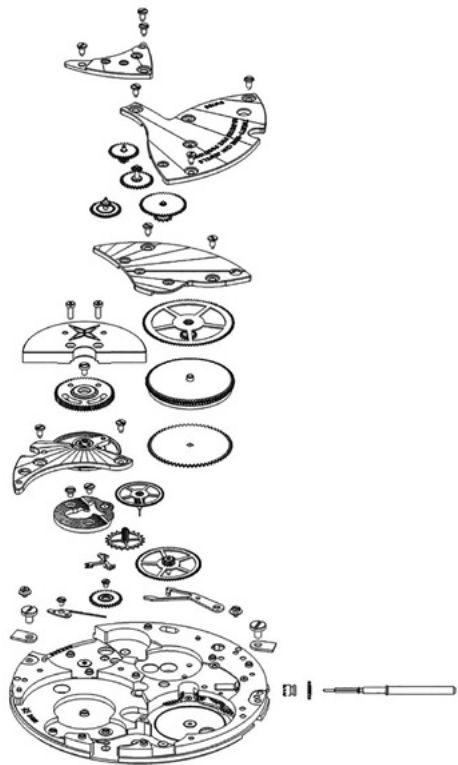

Mechanical self-winding caliber — Vaucher VMF 5401 — Manufacture Fleurier
Swiss-made — Visible through a transparent sapphire crystal caseback — 29 rubies —
48 hours reserve — Water resistant up to 3 bar — 41,5 mm polished steel case — Hours, minutes
and seconds — Seconds in the form of a turning “waltzing” circle at 6 — Black leather strap —
Adjustable triple folding buckle with security push-pieces — solid wooden watch case



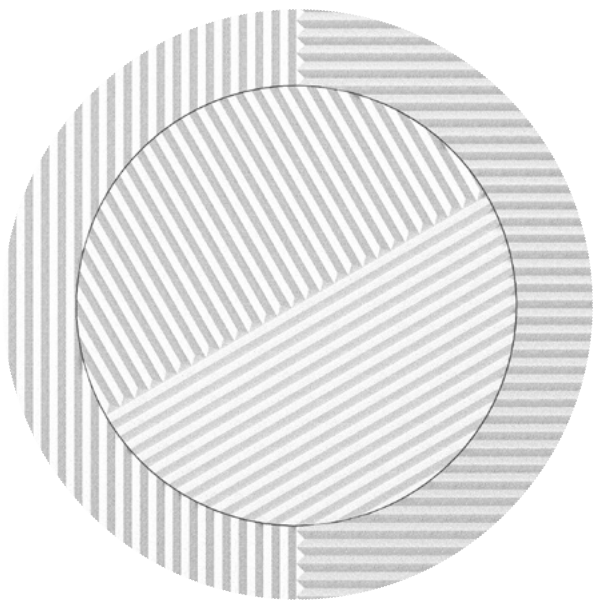

WE DO NOT COUNT SECONDS IN VIENNA

Every full minute, the guilloché-facets of the rotating seconds-disc align with those of the clock face. The movement represents the joyful circles of the Viennese Waltz and the gregarious Viennese Coffee House Culture, in which seconds do not count.





THE WALTZ N°1 MODELS



Black Case
Black Dial



Stainless Steel Case
Blue Dial



Black Case
Silver Dial



Stainless Steel Case
Black Dial



Stainless Steel Case
Silver Dial

80808

WALTZ N°1 SKELETON

800

SPECIAL EDITION 2018

LIMITED TO FIVE WATCHES

The Waltz N°1 Skeleton plays with the juxtaposition of revealing and hiding its sophisticated skeletonized ultra-thin automatic movement.

80808





Stainless Steel Case
Silver Dial



Stainless Steel Case
Black Dial

CARL SUCHY & SÖHNE'S AESTHETICS

The Waltz N°1 Skeleton's 41.5mm dial has been carefully openworked along the subtle horizontal and vertical lines. Thus it reveals just enough to anticipate its refined ultra-thin skeleton movement caliber VMF5401/180.

SOPHISTICATED CRAFTSMANSHIP

Held in stunning black PVD, the openworked bridges are rhodium-plated and finished by the hands of master craftsmen. Fully visible through the transparent sapphire glass bottom, the movement is powered by an expertly finished decentralized micro-rotor providing the watch with 42 hours of autonomy.



WELLNESS FOR YOUR WALTZ N°1

At his Switzerland-based atelier, watchmaker Marc Jenni will personally tend to your Waltz N°1. The services offered range from providing replacement wristbands and polishing to a thorough cleaning of your timepiece. Properly cared for, your Waltz N°1 will serve you a lifetime.

To place a request or book a service, please contact:
sk@carlsuchy.com



TIMELINE

1796 — Carl Suchy is born in the historical centre of Prague.

Until 1819 — watchmaker apprenticeship and years of travel through Germany and Switzerland.

1812–1819 — Years of travel through Germany and Switzerland.

1821 — Carl Suchy marries Josephine Kroupa in Prague.

1822 — 26-year-old Suchy opens his watch shop in the center of Prague. His technically advanced pendulum and wall clocks lead to rapid success.

1830 — Franz Josef, the future emperor of Austria is born, as well as Suchy's second son Anton.

1832 — At the yearly Leipzig Trade Fair, which Suchy attends regularly, his products frequently win prizes. The quality of Suchy's clocks match the market-leading English and Swiss models.

1835 — On occasion of the coronation of emperor Ferdinand I Suchy equips the royal court in Prague with his clocks.

1838 — Suchy's business is growing, by now he has 35 employees. He is one of the first watchmakers to expand internationally.

1841 — Suchy's youngest son, Emanuel Suchy, is born. It is also the year of birth of the famous Austrian architect and city planner Otto Wagner.

1844 — Due to the fact that “his watches exceed highest expectations in regard to elegance and technical perfection”, Carl Suchy is appointed as the first – and for many years the only – watch purveyor to the court.

1848 — Coronation of Emperor Franz Josef I of Austria.

1849 — As Suchy's sons join the family business, it receives its name “Carl Suchy & Söhne” and quickly advances to Austria's most renowned watchmaking company.

1853 — Carl Suchy Junior establishes a pocket watch factory in La Chaux-de-Fonds, Switzerland, place of birth of world-famous architect Le Corbusier. The fac-

tory's products are shipped as far as France and Great Britain. Sigmund Freud is one of Suchy's most loyal customers.

1855–1873 — Carl Suchy & Söhne clocks are regularly displayed at the world fairs in Paris, London and Vienna. The trade press recurrently announces them to be the best Austrian products.

1862 — Artist Gustav Klimt and writer Arthur Schnitzler are born – both will have a tremendous influence on Viennese culture.

1863 — Suchy's second son Hans opens a workshop in Rotenturmstraße 6, in the centre of Vienna. Johann Anton takes over the store in Prague. He is appointed purveyor to the court as well.

1865 — The Viennese Ring Road is opened and Austria's first horse-tramway is installed.

1866 — Founder Carl Suchy dies at age 70. His youngest son Emanuel takes over the workshop in Prague.

1867 — The Blue Danube Waltz by Johann Strauß premieres in Vienna.

1870 — The famous architects and designers Adolf Loos and Josef Hoffmann are born.

1872 — Emanuel Suchy establishes and manages Prague's first volunteer fire brigade.

1879 — Carl Suchy Junior attends the famous Makart procession on the Ring Road, celebrating the twentieth wedding anniversary of Emperor Franz Joseph I of Austria and his wife Elisabeth. Suchy is proudly dressed as a watchmaker from the sixteenth century.

1886 — Sigmund Freud opens his practice in Vienna and develops the method of psychoanalysis.

1891 — The “Young Vienna Movement” coins what is still known as the Viennese coffee-house literature - the meetings and discussions of artists, writers and intellectuals in Viennese cafés shapes the literary movement in and around Vienna. Some of the most renowned members are Peter Altenberg, Arthur Schnitzler, Hugo von Hoffmannsthal and Stefan Zweig.

1894 — Emanuel Suchy receives the prestigious Knight's Cross of

the Imperial Order of Franz Joseph I for his great support of the Prague fire Brigade.

1895 — Otto Wagner, one of the most influential architects of his time announces the end of the ornamental historicism - Jugendstil takes its place. Under the banner of modernism, philosophy, literature, music, art, design and architecture blossom.

1898 — Hans Suchy dies. His widow Therese takes over the shop in the Rotenturmstraße in Vienna. She is also honored as purveyor to the court.

1907 — Adolph Cervinka is the new owner of “Carl Suchy & Söhne” in Prague. The store moves to the exclusive address Na Příkope in the center of the city.

1918 — With the end of the Austro-Hungarian Empire, Carl Suchy & Söhne temporarily takes a creative break.

2017 — It is time again – for Carl Suchy & Söhne.



BUY A WATCH

Die Waltz N°1 can be ordered online through our online-shop or in person by arranging a meeting in Vienna (Austria), Zurich or Lausanne (Switzerland).

For appointments and inquiries please contact: sales@carlsuchy.com

Please visit our homepage for a list of our exclusive dealership network in selected cities worldwide: www.carlsuchy.com



PRESS

Please download our press pack at

www.carlsuchy.com/press

For interview requests, images and further inquiries please contact:

sk@carlsuchy.com



GENERAL CONTACT

Your customer satisfaction is our greatest asset – if you have any questions concerning Carl Suchy & Söhne or Waltz N°1, please don't hesitate to contact us: office@carlsuchy.com



Carl Suchy & Söhne Online

www.carlsuchy.com



CARL SUCHY & SÖHNE
WIEN 1822



