

CARL SUCHY & SÖHNE

WIEN 1822

In 1898, Carl Suchy & Söhne was awarded the prestigious title “Purveyor to the Court“, due to the fact that his watches exceeded the highest expectations in regard to elegance and technical perfection. We continue this tradition by striving for the same ideals: highest quality craftsmanship as well as sophisticated, joyful, surprising and timeless design. Combining Viennese elegance with Swiss precision.





CARL SUCHY JR

Carl Suchy attending the 20th wedding anniversary procession  
of Emperor Franz Joseph I of Austria and Elisabeth (Sissi) in 1879



## IT'S TIME AGAIN FOR CARL SUCHY & SÖHNE

150 YEARS AGO THERE WAS ONLY ONE ADDRESS  
FOR LUXURY WATCHES IN THE AUSTRO-HUNGARIAN  
EMPIRE: CARL SUCHY & SÖHNE. THE LEGENDARY  
AUSTRIAN WATCH BRAND HAS RETURNED AND  
SHINES IN NEW SPLENDOR

There is no proof of Sigmund Freud sneaking a peek at his Carl Suchy & Söhne pocket watch whenever longing for the end of a therapy session – but it's a nice thought to ponder. Fact is, however, the father of psychoanalysis, just as Emperor Franz Joseph I and his wife, Empress Sissi, were amongst the watch brand's most loyal customers.

Founded in 1822 by watchmaker Carl Suchy, the brand soon evolved into a prosperous family business, which, with the help of his four sons, flourished during the 19th and 20th century. First-born son Carl Suchy founded a watch company in the famous Swiss watch manufacturing center of La Chaux-de-Fonds. Meanwhile, his younger brother Hans opened a flagship store on the prominent shopping street Rotenturmstraße in the historical center of Vienna. Carl Suchy & Söhne's watches attracted attention far beyond Austria's borders, delighted the international press at world fairs, were regularly awarded for their "perfect quality and elegance" and brought glamour to royal courts, aristocrats' country estates, and the salons of the intellectual elite. After a short creative break, Carl Suchy & Söhne, the Danube monarchy's most prestigious watchmaker, is back blending today's highest standards of watchmaking and a timeless design with the rich history of the Austro-Hungarian Empire.

# WALTZ N°1

VIENNESE ELEGANCE  
MEETS TECHNICAL EXCELLENCE



Store Location  
Rotenturmstraße, Vienna



Carl Suchy & Söhne flagship store  
at Wenzelsplatz, Prague

Carl Suchy & Söhne returns with the limited-series luxury watch Waltz N°1, made by hand in Switzerland. Carl Suchy & Söhne watches have always displayed highest aesthetics and innovation. All timepieces were signed off personally by the watchmaker himself. To bear his name, they had to “exceed the expectation of the highest classes of society in regard to refined elegance and technical perfection.”

Already during Habsburg times, the Suchy family strongly believed in the unique combination of highest quality materials, timeless Viennese design and Swiss craftsmanship. We deeply respect this tradition. To guarantee the same level of excellence when creating Carl Suchy & Söhne’s watches, we proudly count on the outstanding skills of Marc Jenni, master watchmaker in the third generation and honored member of the exclusive Académie Horlogère des Créateurs Indépendants in Geneva. It takes seven months to manufacture the Waltz N° 1 according to the highest precision standards of Swiss watch manufacturing expertise.



Each Waltz N°1 is handcrafted by Watchmaker Marc Jenni, a former member of the honorable Académie Horlogère des Créateurs Indépendants, at his atelier in Switzerland. It takes seven months to complete the timepieces.



Each Table Waltz is handcrafted by watch master Therese Wibmer, who graduated from the prestigious watchmaking school Karlstein, which was founded by Emperor Franz Joseph I.





# WALTZ N°1



## MINIMALISTIC DESIGN AND HIGHEST-QUALITY CRAFTSMANSHIP

Around 1900, pure lines and understated elegance were the dominating features of Viennese Modernism. The most prominent proponents Josef Hoffmann, Otto Wagner, and Adolf Loos made it one of the most influential design movements of all time. It was the latter's commitment to puristic aesthetic and highest-quality materials that fundamentally inspired the design of our Waltz N°1.

1 — The curvature of the glass is carried on to the casing. 2 — The rounded and polished edging plays with the contrast of matte glazing and reflecting light. 3 — The polished lugs form a line parallel to the bezel and carry on its reflection. 4 — The curved watch-strap emerges from the polished lugs. 5 — The curvatures of the bottom and lower glass together form the conclusive face of the Waltz N°1.

Seamless connections: Design inspired by Adolf Loos can also be found at the divide of bezel and casing.



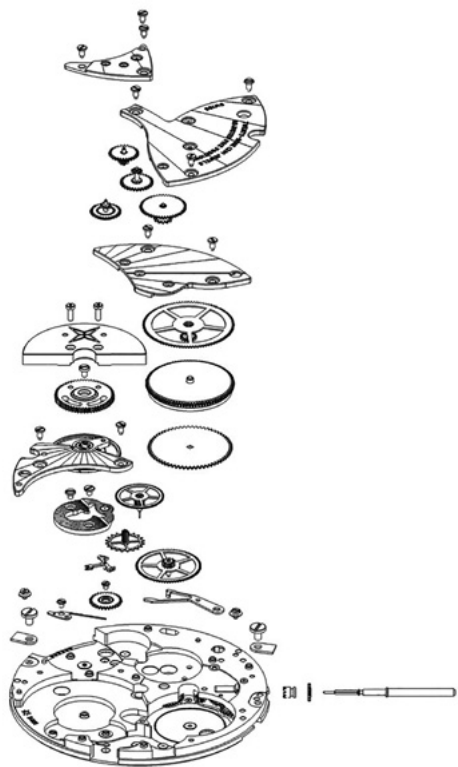

Mechanical self-winding caliber — Vaucher VMF 5401 — Manufacture Fleurier  
 Swiss-made — Visible through a transparent sapphire crystal case back — 29 rubies —  
 48 hours reserve — Water resistant up to 3 bar — 41,5 mm polished steel case — Hours, minutes,  
 and seconds — Seconds in the form of a turning “waltzing” disk at 6 — Black leather strap —  
 Adjustable triple folding buckle with security push-pieces — solid wooden watch case





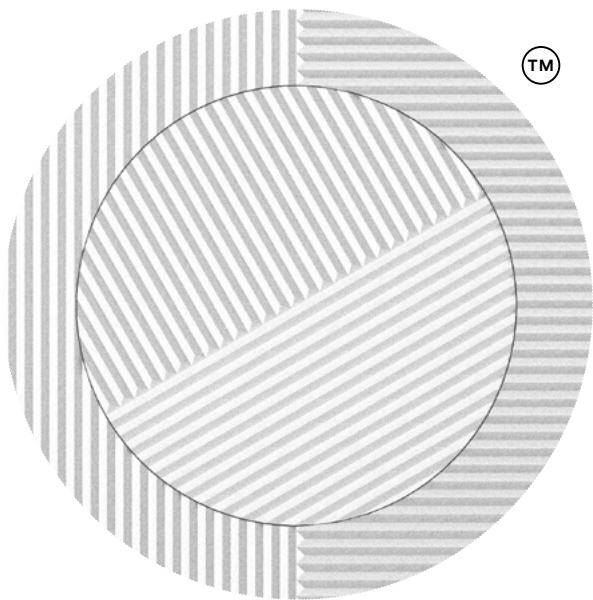

## WE DO NOT COUNT SECONDS IN VIENNA

Every full minute, the guilloché-facets of the rotating second's disc align with those of the dial. The movement represents the joyful circles of the Viennese Waltz and the gregarious Viennese Coffee House culture, in which seconds do not count.





## THE WALTZ N°1 MODELS



Black Case  
Black Dial



Stainless Steel Case  
Blue Dial



Black Case  
Silver Dial



Stainless Steel Case  
Black Dial



Stainless Steel Case  
Silver Dial



8008008

## WALTZ N°1 SKELETON

800

SPECIAL SERIES

The Waltz N°1 Skeleton plays with the juxtaposition of revealing and hiding its sophisticated skeletonized ultra-thin automatic movement.

8008008





Stainless Steel Case  
Silver Dial



Stainless Steel Case  
Black Dial



Stainless Steel Case  
Blue Dial

## CARL SUCHY & SÖHNE'S AESTHETICS

The Waltz N°1 Skeleton's 41.5 mm dial has been carefully openworked along the subtle horizontal and vertical lines. Its unique design reveals just enough to enjoy the view of its refined ultra-thin skeleton movement caliber VMF5401/180.

## SOPHISTICATED CRAFTSMANSHIP

Held in stunning black PVD, the openworked bridges are rhodium-plated and hand-finished by extraordinary craftsmen. Fully visible through the transparent sapphire glass bottom, the movement is powered by a uniquely finished, decentralized micro-rotor providing the watch with 42 hours of autonomy.





## WALTZ N°1 GOLD



SPECIAL SERIES

Special series of Waltz N°1 featuring highest-quality  
18-carat fair trade gold cases.





Gold  
Silver Dial



Gold  
Black Dial

### WALTZ N°1 GOLD

Based on Suchy's sophisticated golden pocket watches of the 19th century which, among many others, psychoanalyst Sigmund Freud found irresistible, and the sparkling gold of Viennese Modernism, as prominently featured in Klimt's famous „Kiss“ or the shiny roof of the Vienna Secession, Carl Suchy & Söhne created an exquisite masterpiece: set in an 18-carat gold case, the Waltz N°1 Gold radiates the imperial splendor of former times and captivates with its contemporary design complementing the watches' high-end automatic movement.

The handcrafted Waltz N°1 Gold is produced in a strictly limited yearly series of 5 pieces.





Black Case  
Silver and Black Dial

### WALTZ N°1 DAY & NIGHT

Flowing design transitions remind of the great designers and architects that shaped the design of Vienna around 1900. Like Yin and Yang, the seconds disc at 6 o'clock dances its circles, bringing together the seemingly contrasting colors in perfect harmony and then again dividing the dial into two perfect halves every full minute.

The Waltz N°1 Day & Night is the perfect companion for your discovery of Austria's capital, uniting the versatile faces the city has to offer: Visit the wonderful imperial sights during the day and set out for a night to remember in one of the many legendary night bars.



## TABLE WALTZ

Pure and contemporary in design, Carl Suchy & Söhne's Table Waltz radiates the elegance of Imperial Vienna. Its silky-smooth 25-cm-case, milled from a single brass piece, tenderly mantels the seemingly floating CS-T-1 in-house movement featuring a pure silver bell that pleasantly chimes by the hour. The hand-polished and engraved glass on the front and back by J & L Lobmeyr fits seamlessly into the conical shape of the brass case. This exceptional and strictly limited-edition timepiece is developed and manufactured in Austria – the first of its kind in over 100 years.

### TECHNICAL FEATURES

CS-T1 in-house movement in characteristic Carl-Suchy- & Söhne-design, made in Austria. Designed by renowned designer Rainer Mutsch. Seven days power-reserve. Hours, minutes, chime on the hour (can be locked). key winder with overwind protection. 14 ruby stones. Dimensions: 25 cm height - 14.5 cm width - 8.5 cm depth. Mainplate: painted brass. Screws: blued steel. Gears: polished brass. Bell: hand-cast silver - blackened. Case: nickel-plated brass. Engraved limitation number.





NEW  
MODEL  
LAUNCH  
SPRING/SUMMER  
22



## BELVEDERE

Elegant Sports Watch, Water Resistant 10 bar,  
Rotating Date Indicator.





## WELLNESS FOR YOUR WALTZ N°1

At his Swiss atelier, our watchmaker Marc Jenni will personally maintain your Waltz N°1. Our services range from providing replacement wristbands and polishing to a thorough cleaning of your timepiece.

To place a request or book a service, please contact:  
[sk@carlsuchy.com](mailto:sk@carlsuchy.com)

# TIMELINE

1796 — Carl Suchy is born in the historical center of Prague.

Until 1819 — watchmaker apprenticeship and years of travel through Germany and Switzerland.

1812–1819 — Years of travel through Germany and Switzerland.

1821 — Carl Suchy marries Josephine Kroupa in Prague.

1822 — 26-year-old Suchy opens his watch shop in the center of Prague. His technically advanced pendulum and wall clocks lead to rapid success.

1830 — Franz Josef, the future emperor of Austria is born, as well as Suchy's second son Anton.

1832 — At the yearly Leipzig Trade Fair, which Suchy attends regularly, his products frequently win prizes. The quality of Suchy's clocks matches the market-leading English and Swiss models.

1835 — On the occasion of the coronation of emperor Ferdinand I Suchy equips the royal court in Prague with his clocks.

1838 — Suchy's business is growing, by now he has 35 employees. He is one of the first watchmakers to expand internationally.

1841 — Suchy's youngest son, Emanuel Suchy, is born. It is also the year of the birth of the famous Austrian architect and city planner Otto Wagner.

1844 — Due to the fact that "his watches exceed highest expectations in regard to elegance and technical perfection", Carl Suchy is appointed as the first – and for many years the only – watch purveyor to the court.

1848 — Coronation of Emperor Franz Josef I of Austria.

1849 — As Suchy's sons join the family business, it receives its name "Carl Suchy & Söhne" and quickly advanced to Austria's most renowned watchmaking company.

1853 — Carl Suchy Junior establishes a pocket watch factory in La Chaux-de-Fonds, Switzerland, the place of birth of world-famous architect Le Corbusier. The fac-

tory's products are shipped as far as France and Great Britain. Sigmund Freud is one of Suchy's most loyal customers.

1855–1873 — Carl Suchy & Söhne clocks are regularly displayed at the world fairs in Paris, London, and Vienna. The trade press recurrently announces them to be the best Austrian products.

1862 — Artist Gustav Klimt and writer Arthur Schnitzler are born – both will have a tremendous influence on Viennese culture.

1863 — Suchy's second son Hans opens a workshop in Rotenturmstraße 6, in the centre of Vienna. Johann Anton takes over the store in Prague. He is appointed purveyor to the court as well.

1865 — The Viennese Ring Road is opened and Austria's first horse-tramway is installed.

1866 — Founder Carl Suchy dies at age 70. His youngest son Emanuel takes over the workshop in Prague.

1867 — The Blue Danube Waltz by Johann Strauß premieres in Vienna.

1870 — The famous architects and designers Adolf Loos and Josef Hoffmann are born.

1872 — Emanuel Suchy establishes and manages Prague's first volunteer fire brigade.

1879 — Carl Suchy Junior attends the famous Makart procession on the Ring Road, celebrating the twentieth wedding anniversary of Emperor Franz Joseph I of Austria and his wife Elisabeth. Suchy is proudly dressed as a watchmaker from the sixteenth century.

1886 — Sigmund Freud opens his practice in Vienna and develops the method of psychoanalysis.

1891 — The "Young Vienna Movement" coins what is still known as the Viennese coffee-house literature - the meetings and discussions of artists, writers, and intellectuals in Viennese cafés shape the literary movement in and around Vienna. Some of the most renowned members are Peter Altenberg, Arthur Schnitzler, Hugo von Hoffmannsthal and Stefan Zweig.

1894 — Emanuel Suchy receives the prestigious Knight's Cross of

the Imperial Order of Franz Joseph I for his great support of the Prague fire Brigade.

1895 — Otto Wagner, one of the most influential architect of his time announces the end of ornamental historicism - Jugendstil takes its place. Under the banner of modernism, philosophy, literature, music, art, design, and architecture blossom.

1898 — Hans Suchy dies. His widow Therese takes over the shop in the Rotenturmstraße in Vienna. She is also honored as a purveyor to the court.

1907 — Adolph Cervinka is the new owner of "Carl Suchy & Söhne" in Prague. The store moves to the exclusive address Na Příkope is in the center of the city.

1918 — With the end of the Austro-Hungarian Empire, Carl Suchy & Söhne temporarily takes a creative break.

2017 — It is time again – for Carl Suchy & Söhne.





#### BUY A WATCH

Online through our online shop, [www.carlsuchy.com](http://www.carlsuchy.com)

At our atelier or offices in Vienna, Zurich, or Lausanne - please arrange  
a meeting contacting [sales@carlsuchy.com](mailto:sales@carlsuchy.com)

In one of the exclusive boutiques of our partners - please visit our  
homepage for a list of our worldwide dealership network



#### PRESS

Please download our press pack at  
[www.carlsuchy.com/press](http://www.carlsuchy.com/press)

For interview requests, images, and further inquiries please contact:  
[sk@carlsuchy.com](mailto:sk@carlsuchy.com)



#### GENERAL CONTACT

Your customer satisfaction is our greatest asset –  
if you have any questions concerning Carl Suchy & Söhne or Waltz N°1,  
please don't hesitate to contact us: [office@carlsuchy.com](mailto:office@carlsuchy.com)



Carl Suchy & Söhne Online  
[www.carlsuchy.com](http://www.carlsuchy.com)







[WWW.CARLSUCHY.COM](http://WWW.CARLSUCHY.COM)

